

## Highlights

- Multiple temperature and spectral ranges
- Local user-interface for sensor programming
- User-selectable 0/4-20 mA, 0-5 V, J or K thermocouple output
- User-scalable 0/4-20 mA or 0-5 V output
- Simultaneous analog and digital RS485 outputs
- Choice of terminal wiring or DIN connector wiring
- Laser sighting for high resolution optics (LTHSF, LTCF2)
- Optional stainless steel housing
- Field Calibration software

# XR

## Datasheet



### Electrical Specifications

<b>Outputs</b>	
Analog	4-20 mA, 0-20 mA, 0-5V, J or K thermocouple (with terminal connector)
Digital	RS485 (bidirectional)
Alarm	opto-coupled contact closure
<b>Inputs</b>	
	Emissivity setting, background radiation compensation, trigger, laser control
<b>Power Supply</b>	24 VDC ±20%, 100 mA

### General Specifications

<b>Environmental Rating</b>	IP65 (IEC529), with DIN connector only
<b>Ambient Temperature</b>	
without cooling	0 to 70°C
with air cooling	120°C
with water cooling	175°C
with ThermoJacket	315°C
with laser	40°C
<b>Storage Temperature</b>	-20 to 70°C
<b>Relative Humidity</b>	10 to 95%, non-condensing
<b>Shock</b>	IEC 68-2-27, 50 G, 11 ms, 3 axis
<b>Vibration</b>	IEC 68-2-6, 3 G, 11 – 200 Hz, 3 axis
<b>Dimension</b>	
with cooling jacket	192 mm L x 42 mm diameter
	192 mm L x 63 mm diameter
<b>Weight</b>	
	585 g
with cooling jacket	675 g

### Measurement Specifications

<b>Temperature/Spectral Ranges</b>		
LT/LTHSF (Low Temp.)	-40 to 600°C	8 to 14 μm
MT (Medium Temp.)	250 to 1200°C	3,9 μm
G5 (Glass)	250 to 1650°C	5,0 μm
P7 (Plastic)	10 to 350°C	7,9 μm
<b>Optical Resolution<sup>1</sup></b>		
LTHSF	50 : 1	
LT, G5	33 : 1	
MT, P7	30 : 1	
<b>System Accuracy</b>		
	±1% or ±1,0°C <sup>2,3</sup>	
<b>Repeatability</b>		
	±0,5% or ±0,5°C <sup>3,4</sup>	
<b>Temperature Resolution</b>		
P7	1,0°C	
all other models	0,5°C	
<b>Response Time (95%)</b>		
all models	150 ms	
<b>Emissivity</b>		
	adjustable: 0,100 to 1,100	
<b>Signal Processing</b>		
	°C/°F, Min, Max, Average, advanced hold, ambient background temperature compensation	

<sup>1</sup> 90% energy, standard focus optics

<sup>2</sup> at ambient temperature 23°C ± 5°C

<sup>3</sup> whichever is greater

<sup>4</sup> LT: for target temperature > 25°C @ ambient temperature of 23°C; P7: for target temperature > 95°C

### Sensor and Fixed Bracket

Each sensor comes with a fixed bracket, a mounting nut, a software CD and an operator's manual.

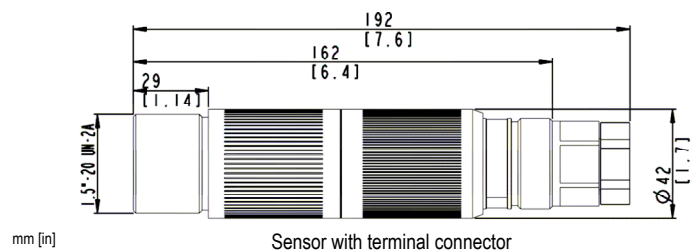
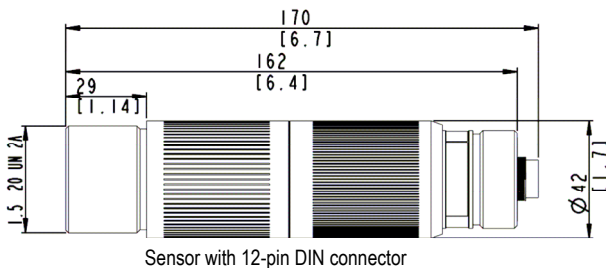

## Options

Options must be specified at time of order.

- ISO Calibration Certificate, based on NIST/DKD certified probes (XXXXRCERT)

## Accessories

- RS232/485 converter serving for stand-alone or multiple sensors (RAYMINCONV2)
- Protective Window according to spectral range (XXXTXACTW...)
- Cable extensions in lengths of 4, 8, 15, 30 m - high (200°C) or low (85°C) temperature
- Water/Air Cooled Housing for field retrofit as stainless steel (XXXXRACWCS) or aluminium (XXXXRACWCA)
- ThermoJacket: extra rugged cast metal housing for thermal/mechanical environmental protection (RAYTXXTJ5), see also ThermoJacket datasheet

### Fixed Bracket (XXXTXXACFB)

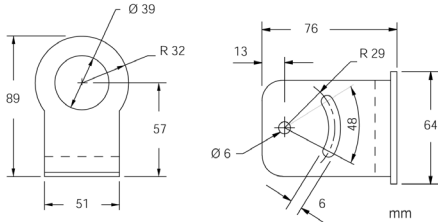

### Adjustable Bracket (XXXTXXACAB)

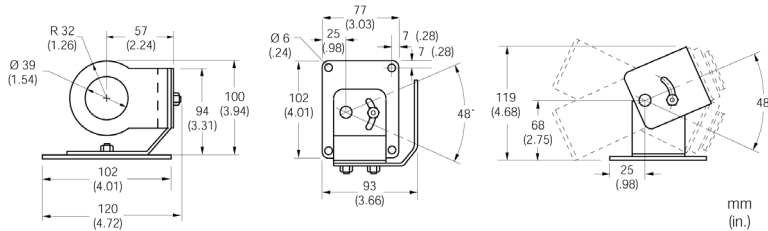

### Air Purge Collar (XXXTXXACAP)

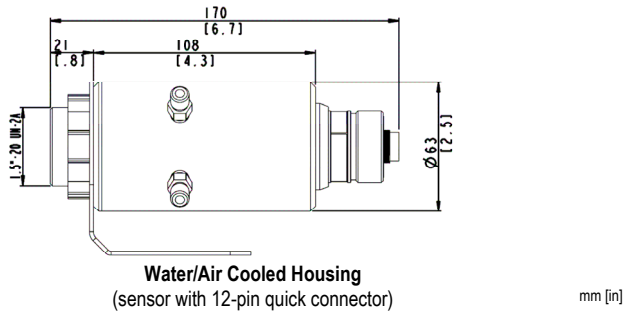
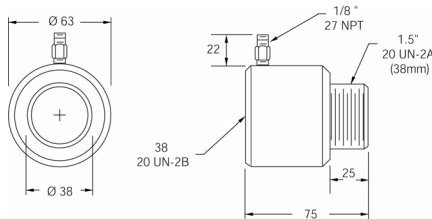

Water/Air Cooled Housing  
(sensor with 12-pin quick connector)

## Optical Specifications

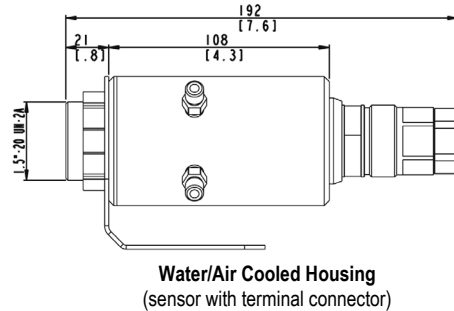
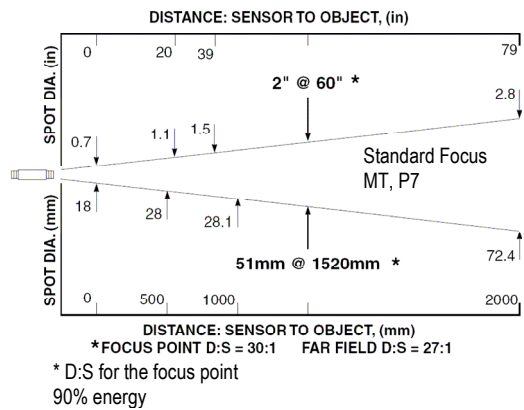
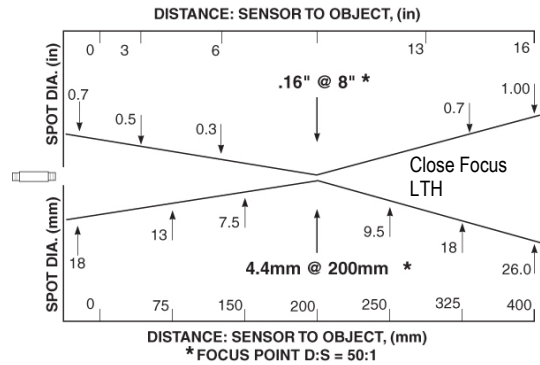
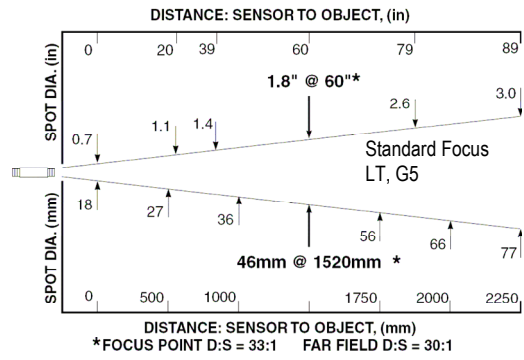

Water/Air Cooled Housing  
(sensor with terminal connector)

[www.raytek.com](http://www.raytek.com)  
for up-to-the-minute features

57502, Rev. A, 08/2007 - Raytek and the Raytek logo are registered trademarks of Raytek Corporation. Specifications subject to change without notice. Raytek is ISO 9001 certified.

**Worldwide Headquarters**  
Raytek Corporation  
Santa Cruz, CA USA  
Tel: +1 831 458 - 1110  
+1 800 227 - 8074  
Fax: +1 831 458 - 1239  
[automation@raytek.com](mailto:automation@raytek.com)

**United Kingdom**  
Tel: +44 1908 630 800  
Fax: +44 1908 630 900  
[ukinfo@raytek.com](mailto:ukinfo@raytek.com)

**European Headquarters**  
Raytek GmbH  
Berlin, Germany  
Tel: +49 30 47 80 08 - 0  
Sales: - 400  
Fax: +49 30 4 71 02 51  
[raytek@raytek.de](mailto:raytek@raytek.de)

**France**  
Tel: 0800 888 244  
[info@raytek.fr](mailto:info@raytek.fr)



**Raytek**<sup>®</sup>  
A Fluke Company